



**Item No.: 968635**  
**Holder with Tilt Swivel**  
**and Cigarette Lighter Charger**

Palm Treo 600  
Palm Treo 650

**Installation Instruction**

**Overview Picture**

**Please read all of the instructions and look at the pictures before attaching the ProClip.**

**ProClip USA** may not be held liable for any damage to a vehicle before, during or after the installation or removal of this Holder.

**ProClip USA** may not be held liable for any personal injury resulting from accident or improper use or installation.

**The ProClip** Holder in the installation pictures may look slightly different from the one you have received. However, the same instructions apply.



**Note:** The holder can be attached to any mounting bracket or flat surface with the applicable screws enclosed - self-tapping screws if the mount has small holes or machine screws with nuts if the mount has large holes.

1.  
Unscrew the screw in the center of the Holder and remove the holder from the Tilt Swivel base plate.



2.  
Place the Tilt Swivel base plate over the matching holes in your mounting bracket (demo ProClip mount shown in picture) Attach the base plate by using the applicable screws enclosed - self-tapping screws if the mounts has small holes or machine screws with nuts if the mount has large holes.

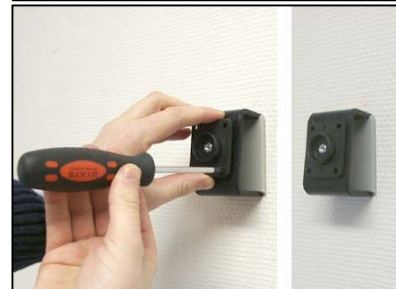

3.  
Place the Holder onto the Tilt Swivel base plate and attach it with the center screw. This screw also controls the pivot, tighter for a firm hold and lose for more (easier) movement/angling of the holder.

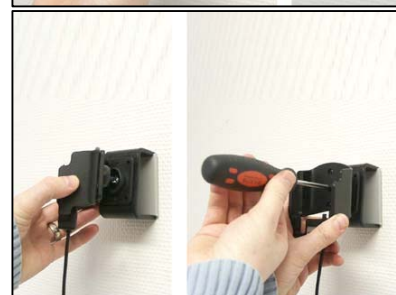

4.  
Slide the device down into the holder so it connects to the bottom connector. To remove the device from the Holder, pull the device up and out.

