



Item No.: 875214
Adjustable Holder with Tilt Swivel

Apple iPhone 1st Generation in a skin or case
/Apple iPhone 2nd Generation (3G) in a skin or case
/Apple iPod Touch in a skin or case /Apple
iPod Classic 80/120 GB in a skin or case

Adjusts from 2.3" (60mm) to 3.2" (82mm)

Installation Instruction

Overview Picture

Please read all of the instructions and look at the pictures before attaching the ProClip.

ProClip USA may not be held liable for any damage to a vehicle before, during or after the installation or removal of this Holder.

ProClip USA may not be held liable for any personal injury resulting from accident or improper use or installation.

The ProClip Holder in the installation pictures may look slightly different from the one you have received. However, the same instructions apply.



Note: The Holder can be attached to any mounting bracket or flat surface with the applicable screws enclosed - self-tapping screws if the mount has small holes or machine screws with nuts if the mount has large holes.

1.
To adjust the holder to your unit: Loosen the screws on the back side of the holder, so the sides of the holders can be adjusted. Place the unit in the holder and press the sides together so the unit is firmly in place. Screw on the screws on the back side of the holder.



2.
Unscrew the screw in the center of the Holder and remove the Holder from the Tilt Swivel base plate.



3.
Place the Holder onto the Tilt Swivel base plate and attach it with the center screw. This screw also controls the pivot, tighter for a firm hold and loose for more (easier) movement/angling of the Holder.

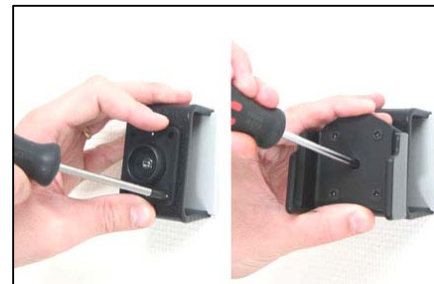

4.
Slide the device down into the Holder. To remove the device from the Holder, slide it up and out.

