



**Item No.: 215058
4 Prong (Richter)
Vehicle Mount Adapter
with Tilt Swivel**

Works with all devices/device cradles that have 4 Female T holes in the back.

Installation Instruction

Overview Picture

Please read all of the instructions and look at the pictures before attaching the ProClip.

ProClip USA may not be held liable for any damage to a vehicle before, during or after the installation or removal of this Adapter Plate.

ProClip USA may not be held liable for any personal injury resulting from accident or improper use or installation.

The ProClip Adapter in the installation pictures may look slightly different from the one you have received. However, the same instructions apply.



Note: The 4 Prong (RICHTER) Vehicle Mount Adapter can be attached to any mounting bracket or flat surface with the applicable screws enclosed - self-tapping screws if the mount has small holes or machine screws with nuts if the mount has large holes.

1. Insert a Philips screw driver into the center hole and unscrew the screw. Release the Adapter Plate from the base plate.



2. Place the Tilt Swivel base plate over the matching holes in your mounting bracket (demo ProClip mount shown in picture) Attach the base plate by using the applicable screws enclosed – self-tapping screws if the mount has small holes or machine screws with nuts if the mount has large holes.

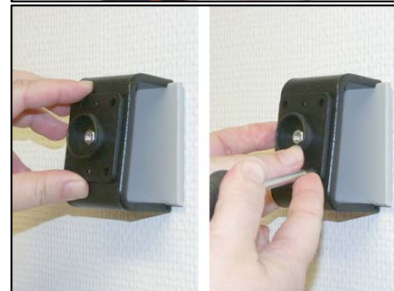

3. Place the Adapter Plate onto the base plate and attach it with the center screw. This screw also controls the pivot, tighter for a firm hold and loose for more (easier) movement/angling of the Adapter Plate.

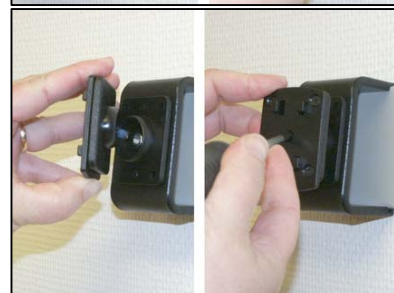

4. Now that the Adapter Plate is in place, find your device cradle, which is usually enclosed with your device when purchased. Hook your device/device cradle onto the T prongs and slide it down. (Demo cradle shown in picture) To remove it, slide the device/device cradle up and unhook it from the T prongs.

